

Orchid Woods

2 & 3 BHK APARTMENTS

cheerful community living



**Goyal
&Co.**

creating landmarks since 1971



**HARIYANA
GROUP**

A JOINT VENTURE OF
GOYAL & CO., AHMEDABAD & HARIYANA GROUP, MUMBAI

promising less giving more

Orchid Woods is being developed in partnership with the Hariyana Group. Positioned in a fast growing region of Bangalore, it presents a sensible and value-driven opportunity for homeowners. Personifying practical architecture, the freehold development features sober and well-engineered apartment designs to ensure maximum functionality and cost efficiency.



Orchid Woods

welcome to the world of
cheerful living



One of the most promising residential projects launched in recent times in Bangalore, Orchid Woods is a pure opportunity for buyers! Personifying practical architecture, the freehold development features sober and well-engineered apartments designs to ensure maximum functionality and cost efficiency.





cheerful community living



All properties are designed with ample internal spaces that take full advantage of views and cheerful living.

Orchid Woods, while striking and elegant in appearance, allows for all facades to utilize the higher level views, thereby avoiding dark internal spaces.

site plan



Orchid Woods, the stylish signature building caters to every possible aspect of modern living, making a permanent mark within the Garden city, Bangalore.

Hennur Main Road



legends for amenities

1.	Entry / Exit
2.	Guard house
3.	Seating area with water feature and terraces
4.	Feature paving
5.	Celebration lawn
6.	Feature wall
7.	Timber deck
8.	Infinity pool with floating sculpture
9.	Palm bosque
10.	Swimming pool & kids pool
11.	Pool deck
12.	Feature wall with spout

13.	Trellis
14.	Lawn
15.	Toddler play court
16.	Children play area
17.	Basketball practice court
18.	Barbeque
19.	Driveway
20.	Jogging track
21.	Car park
22.	Feature paving for tower drop off
23.	Healing garden with herbal garden and reflexology path

Clubhouse Amenities

- Fitness Centre
- Table tennis
- Indoor Games Lounge
- Party Hall





each of these amenities is designed to enhance the
residents' experience



a splash of fun!

A user-friendly housing development, Orchid Woods that totally merges with its environs, spells out the promise of a convenient, comfortable and lavish lifestyle.

At Orchid Woods, unique architectural details combine in perfect harmony to provide elegant living spaces and vast open spaces, surrounded by green and blue environs.





typical floor



first floor



fourteenth floor



unit plans block A

FIRST FLOOR		BLOCK-A
FLAT No.	AREA	
01	1109 SQ. FT.	
02	1418 SQ. FT.	
03	1389 SQ. FT.	
04	1104 SQ. FT.	

TYPICAL FLOOR		BLOCK-A
FLAT No.	AREA	
01	1197 SQ. FT.	
02	1534 SQ. FT.	
03	1505 SQ. FT.	
04	1197 SQ. FT.	

FOURTEENTH FLOOR		BLOCK-A
FLAT No.	AREA	TERRACE
01	1164 SQ. FT.	-
02	1322 SQ. FT.	105 SQ. FT.
03	1293 SQ. FT.	105 SQ. FT.
04	1171 SQ. FT.	-



block arrangement

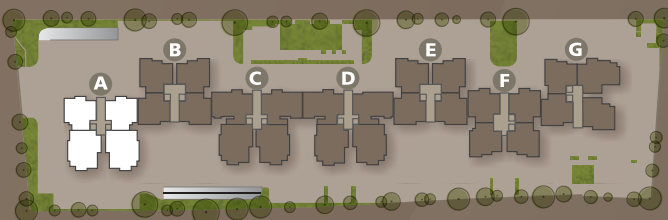

Orchid Woods

Orchid Woods epitomizes a unique balance between tradition and modernity. The distinctive architecture of this property development is a throwback on the style that its interior spaces help residents enjoy the comforts of the present.



typical floor



unit plans
block **B, E & F**

first floor

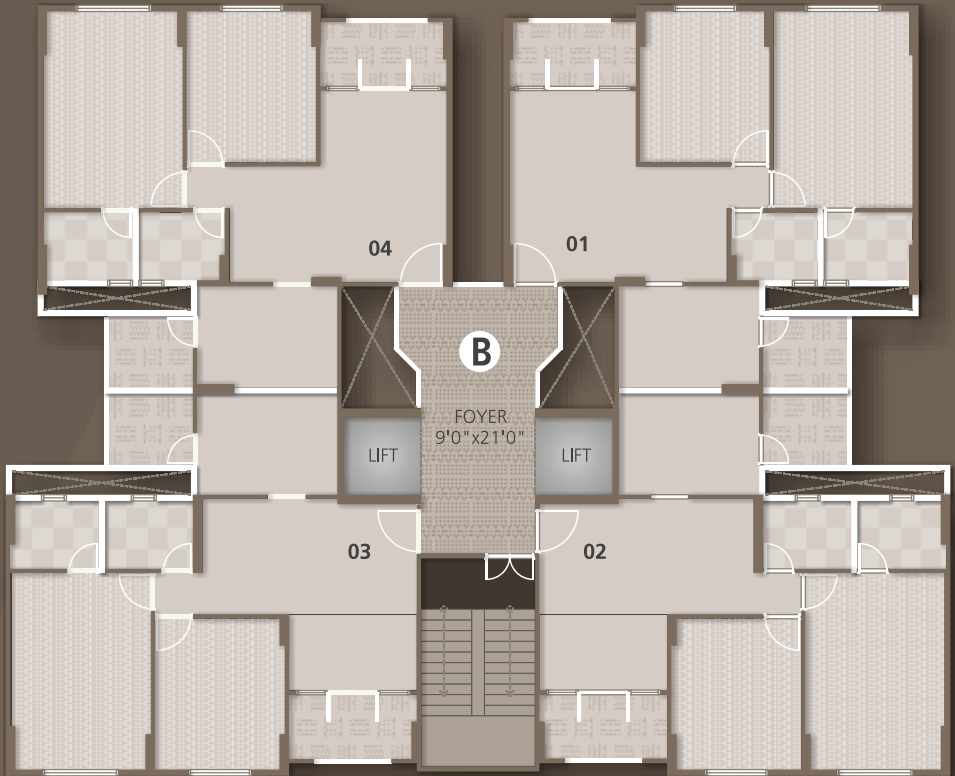

fourteenth floor

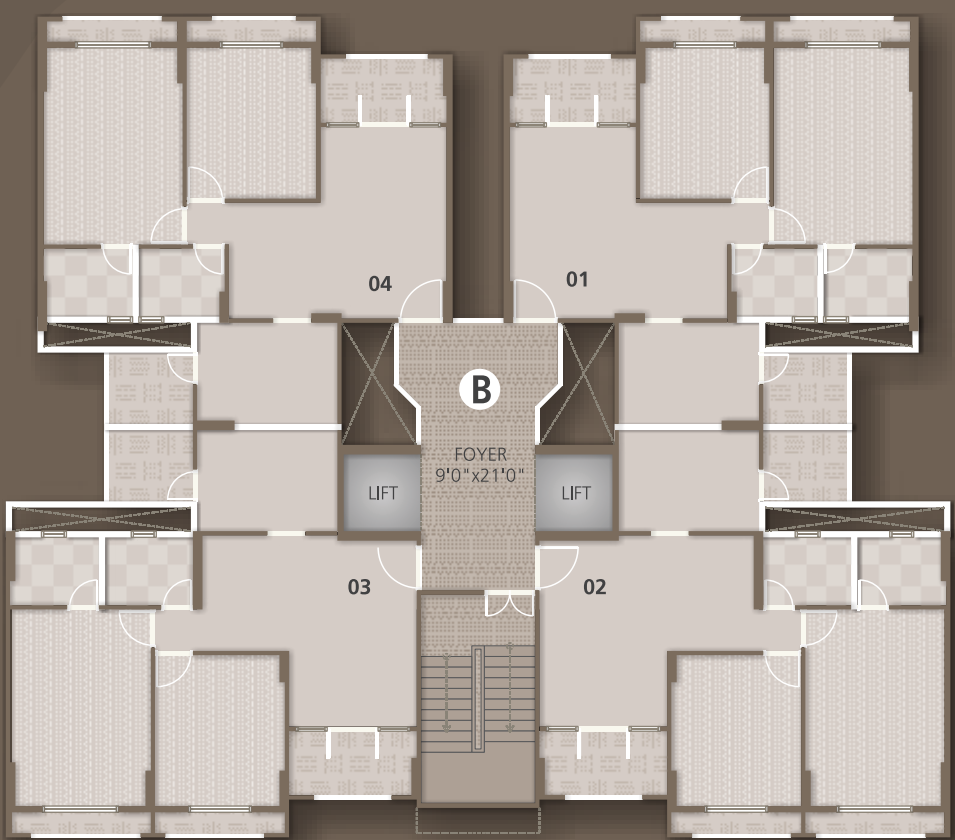

FIRST FLOOR			
FLAT	BLOCK-B	BLOCK-E	BLOCK-F
01	1093 SQ. FT.	1093 SQ. FT.	1095 SQ. FT.
02	1093 SQ. FT.	1095 SQ. FT.	1099 SQ. FT.
03	1096 SQ. FT.	1096 SQ. FT.	1095 SQ. FT.
04	1093 SQ. FT.	1091 SQ. FT.	1097 SQ. FT.

TYPICAL FLOOR			
FLAT	BLOCK-B	BLOCK-E	BLOCK-F
01	1182 SQ. FT.	1182 SQ. FT.	1173 SQ. FT.
02	1151 SQ. FT.	1151 SQ. FT.	1189 SQ. FT.
03	1151 SQ. FT.	1151 SQ. FT.	1185 SQ. FT.
04	1182 SQ. FT.	1179 SQ. FT.	1182 SQ. FT.

FOURTEENTH FLOOR			
FLAT	BLOCK-B	BLOCK-E	BLOCK-F
01	1148 SQ. FT.	1148 SQ. FT.	1149 SQ. FT.
02	1150 SQ. FT.	1152 SQ. FT.	1154 SQ. FT.
03	1154 SQ. FT.	1153 SQ. FT.	1150 SQ. FT.
04	1148 SQ. FT.	1146 SQ. FT.	1151 SQ. FT.



block arrangement

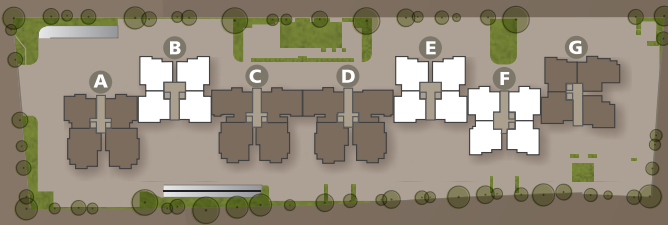

typical floor



first floor

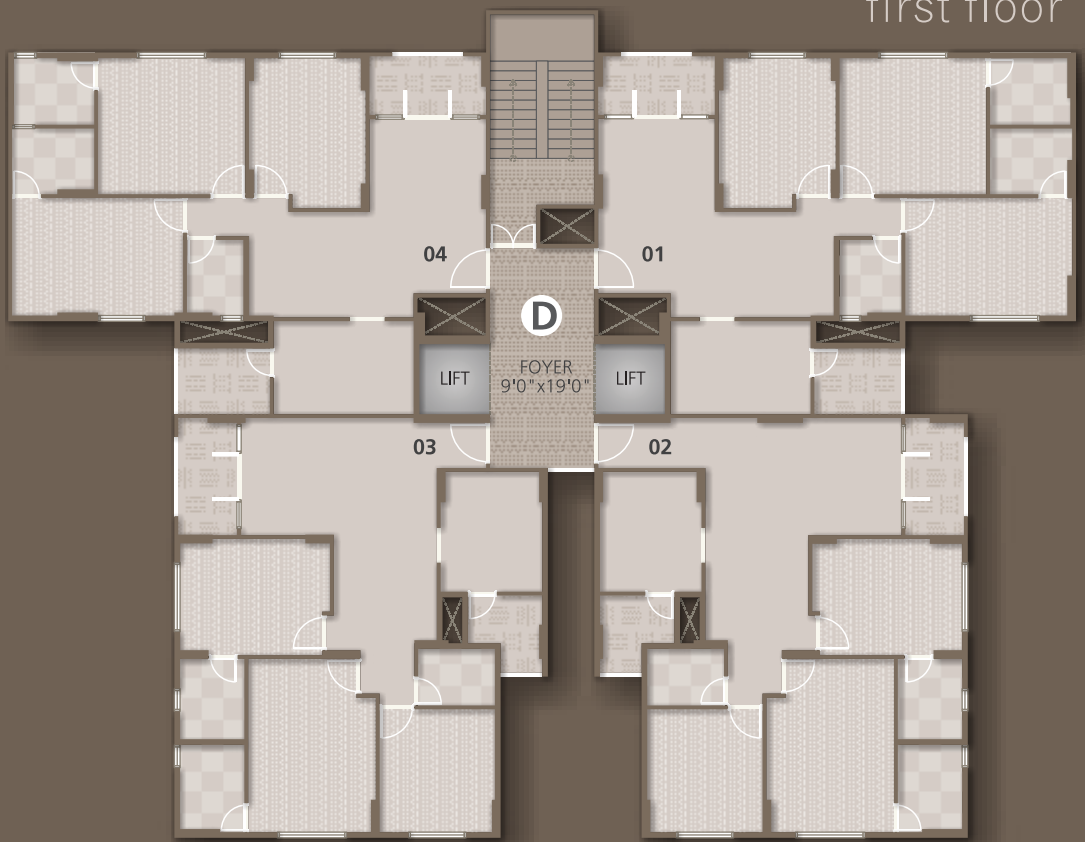

fourteenth floor



unit plans
block C & D

FIRST FLOOR		
FLAT	BLOCK-C	BLOCK-D
01	1430 SQ. FT.	1427 SQ. FT.
02	1392 SQ. FT.	1421 SQ. FT.
03	1421 SQ. FT.	1392 SQ. FT.
04	1427 SQ. FT.	1430 SQ. FT.

TYPICAL FLOOR		
FLAT	BLOCK-C	BLOCK-D
01	1518 SQ. FT.	1488 SQ. FT.
02	1505 SQ. FT.	1534 SQ. FT.
03	1534 SQ. FT.	1505 SQ. FT.
04	1488 SQ. FT.	1518 SQ. FT.

FOURTEENTH FLOOR		
FLAT	BLOCK-C	TERRACE
01	1290 SQ. FT.	123 SQ. FT.
02	1297 SQ. FT.	105 SQ. FT.
03	1326 SQ. FT.	105 SQ. FT.
04	1487 SQ. FT.	-

FOURTEENTH FLOOR		
FLAT	BLOCK-D	TERRACE
01	1286 SQ. FT.	123 SQ. FT.
02	1326 SQ. FT.	105 SQ. FT.
03	1297 SQ. FT.	105 SQ. FT.
04	1290 SQ. FT.	123 SQ. FT.

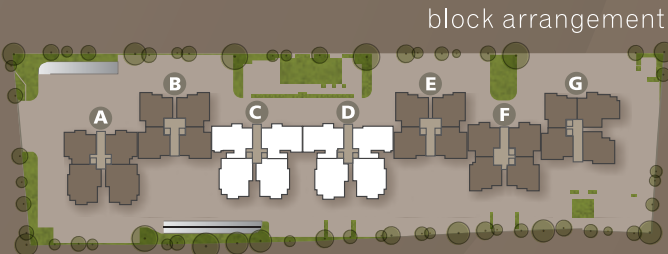



Orchid Woods

The living spaces of every apartment have been painstakingly finished to high standards of quality. All 2 & 3 bedroom apartments feature a unique floor plan that affords you panoramic views of the landscaped surrounds and has been tastefully designed with luxury and the ultimate convenience in mind.



typical floor



first floor



fourteenth floor



unit plans block G

FIRST FLOOR		BLOCK-G
FLAT No.	AREA	
01	1408 SQ. FT.	
02	1102 SQ. FT.	
03	1093 SQ. FT.	
04	1105 SQ. FT.	

TYPICAL FLOOR		BLOCK-G
FLAT No.	AREA	
01	1526 SQ. FT.	
02	1159 SQ. FT.	
03	1151 SQ. FT.	
04	1194 SQ. FT.	

FOURTEENTH FLOOR		BLOCK-G
FLAT No.	AREA	TERRACE
01	1292 SQ. FT.	125 SQ. FT.
02	1159 SQ. FT.	-
03	1150 SQ. FT.	-
04	1159 SQ. FT.	-

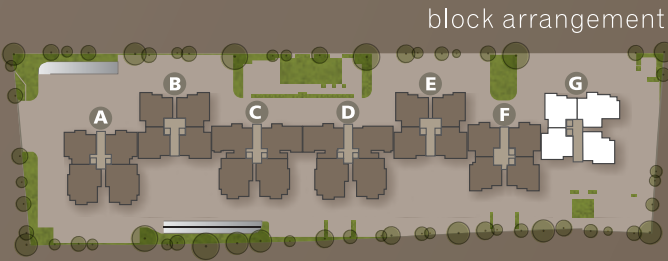

Orchid Woods

For us kitchen and dining space are the most valuable space of a home. We call it a 'power house' of a home, where all get together and get the feel of unity and its strength.

We have taken particular care in planning your 'power house' with good dimensions, air circulation and functional values to respect your unity.





Orchid Woods

SPECIFICATIONS

STRUCTURE

- Seismic Zone II compliant structure
- Solid Block Masonry

WALL FINISHING

- Internal Walls and Ceiling finished with Oil Bound Distemper
- External Walls painted with weather coat /weather shield paints

FLOORING

- Vitrified Tiles for complete flat
- Ceramic tiles for balconies and utility areas
- Lobbies with rustic/ vitrified tiles
- Staircases with Polished kota stone / granite

DOORS & WINDOWS

- Main doors with teak wood frames and teak finish flush doors
- Other doors with sal wood frames with moulded panel doors
- Powder coated aluminium / UPVC windows and balcony doors with plain glass in two tracks, Only three track in balconies

KITCHEN

- Kitchen counter 20mm thick granite with single drain board sink
- Cladding with ceramic tiles 2' above the kitchen platform

TOILETS

- Ceramic Tiles dado upto 7' height
- Grid False Ceiling
- Polished granite counter with ceramic basin
- C P fittings of Jaquar or equivalent
- EWC and Ceramic basins of Cera or equivalent in all toilets

ELECTRICAL

- 2 BHK : 4 KW KPTCL supply & .75 KW DG back up
- 3 BHK : 5 KW KPTCL supply & 1 KW DG back up
- 100% DG back up for pumps, lifts and common area

WATER SUPPLY

- CPVC line for water supply
- UPVC / PVC lines for soil, drainage and external lines
- Sewage Treatment Plant
- Rain water harvesting system

LIFTS

- 2 automatic lifts for each tower

SPECIAL NOTES :

- The developers reserve the rights to change or revise or make any modifications, additions, omissions or alterations in the scheme as a whole or any part there of or any details there in, at their sole discretion without any prior notice. Such changes would be binding to all the members.
- All the architectural and interior views in brochure are computer graphic simulated interpretation of the actual property.
- All the dimensions given are approximate & from unfinished surfaces.
- This brochure is just for an easy presentation of the project and should not be treated as a legal document.
- Additional details as per attached leaflet here with.

Orchid Woods

cheerful community living



A JOINT VENTURE OF
GOYAL & CO., AHMEDABAD &
HARIYANA GROUP, MUMBAI

206, BARTON CENTRE, 84,
M.G. ROAD, BANGALORE - 560001
Phone: +91-80-25325716 / 17
Email: orchidwoods@goyalco.com
Web: www.goyalco.com

SALES

Phone: 9972091111 / 9901042222