

# PURAVANKARA



Actual picture of Purva Venezia

**PURVA**  
**VENEZIA**  
Luxury apartments, Yelahanka  
The spirit of Venice in Bengaluru

## COME HOME TO A TRULY INTERNATIONAL LIFESTYLE

Purva Venezia is inspired by the magical landscape of Venice. Whether it is the sparkling waterways, the arched bridges or the manicured gardens, the richness, colour, light and texture will leave you mesmerized.

Every aspect of this high-end home is thoughtfully designed - be it the vitrified flooring, the ornate lobby or even the water treatment plant. Your home will be so self-contained that you may never have to step out for days on end. A supermarket, a gym, a swimming pool, a health spa, a jacuzzi, a tennis court and many more amenities offer you a lifestyle that is truly unmatched.

If you've always believed in high quality living, it's time to put your beliefs into action. With a view of 1600 acres of greenery belonging to the University of Agricultural Sciences and an ideal location, Purva Venezia offers you a lifestyle that is too good to resist.



Actual picture of Purva Venezia

**PURVA**  
**VENEZIA**  
Luxury apartments, Yelahanka  
The spirit of Venice in Bengaluru



## MASTER PLAN





## AMENITIES

Entertainment Centre | Aerobics and Meditation Room | Card Room | Squash Court | Billiards Room | Table Tennis | Basketball Post | Badminton Court | Gymnasium | Steam & Sauna | Jacuzzi | Swimming Pool (Indoor and Outdoor) | Outdoor Children's Play Area | Tennis Court | Amphitheatre | Provision for Concierge | Provision for Restaurant | Provision for Cocktail Lounge | Provision for Supermarket | Provision for Health Care Centre | Provision for Launderette | Provision for Party Hall

## PROJECT INCLUDES

Water Treatment Plant | State-of-the-art Fire Protection Systems | Meandering Water Course and Venetian Landscaped Garden | Well-lit and decorated Entrance Lobbies finished in Highly Polished Granite



## PROJECT SPECIFICATIONS

### STRUCTURE:

- RCC framed structure

### LOBBY & STAIRCASE:

- Elegant ground floor lobby with highly polished granite/imported /Italian marble flooring

### APARTMENT FLOORING:

- Vitrified tiles in Living, dining, bedrooms, living & dining balcony, passages leading to bedrooms & attached balconies

### KITCHEN & UTILITY:

- Vitrified tile flooring in kitchen & utility area
- Rectified/vitrified tile dado up to 2' ht roof above kitchen counter
- Highly polished granite for kitchen counter top
- Double bowl, single drain stainless steel sink with premium quality (Jaguar or equivalent) hot and cold basin mixer
- Provision for water purifier above the drain board

### BATHROOMS:

- Anti skid/matt ceramic designer tile flooring
- Colored glazed designer tiles with designer border up to the false ceiling
- Master bathroom – Bathtub and granite/marble counter-top wash basin (Jaguar or equivalent brand) with bottle trap
- Other bathrooms – Shower area with ledge, wash basin with pedestal
- All bathrooms will have good quality vitreous pastel colored wall mounted EWC (button type) with premium quality (Jaguar or equivalent brand) CP fittings & sanitary fixtures

### DOORS:

- Main door – engineered door with sufficient thickness to in house good quality hardware with security eye
- Bedroom doors & bathroom doors – engineered door with good quality hardware
- Balconies for living & dining – Glazed French UPVC windows
- Other balconies & Utility door-glazed door and window with UPVC frames with sliding shutters

### WINDOWS:

- UPVC frames with glazed, sliding/hinged shutters with mosquito mesh

### VENTILATORS

- UPVC with glazed, louvered/hinged ventilators
- Provision for exhaust fan

### PAINTING:

- Acrylic based paint & textures surfaces in selective places as per design for exterior fascia of the building
- Interior walls are painted in oil bound distemper

### BALCONY RAILINGS:

- Ornamental railings as per architect's design

### CEILING:

- Cornices in living, dining, foyer & in passage areas

### STAIR HANDRAILS:

- Railings as per architect's design

### ELECTRICAL:

- All electrical wiring is concealed with premium quality PVC conduits
- Adequate power outlets for lights, fans, exhaust-fans, call-bell, television and telephone points are provided in the apartment
- Two (2) AC points in Master bedroom & Guest bedroom
- Telephone & Television points in living area and all bedrooms and provision for cable TV connection
- Internet connectivity in all bedrooms
- 7 KW power will be provided for 3 BHK, 5 KW power for 2 BHK.

### ELEVATORS

- Hi-speed Automatic passenger lifts are provided in each block with intercom facility connected to security cabin

### D G POWER:

- Back-up for common area lighting, pumps and lifts.
- 3 KW of D.G. power backup is provided for 3 BHK, 2 KW for 2 BHK

### INTRA COMMUNICATION SYSTEM:

- Intra-communication facility from apartment to apartment and to security cabin within the complex

### VISITOR CAR PARK:

- Ample visitor car parking available

## UNIT PLANS



**2 BHK**  
Type A – 1322 sq. ft.



**3 BHK**  
Type C – 1610 sq. ft.

- 2 BED ROOM UNIT (TYPE A) 1322 SFT.
- 2 BED ROOM UNIT (TYPE B) 1327 SFT.
- 3 BED ROOM UNIT (TYPE C) 1610 SFT.
- 3 BED ROOM UNIT (TYPE D) 1614 SFT.
- 3 BED ROOM UNIT (TYPE E) 1780 SFT.

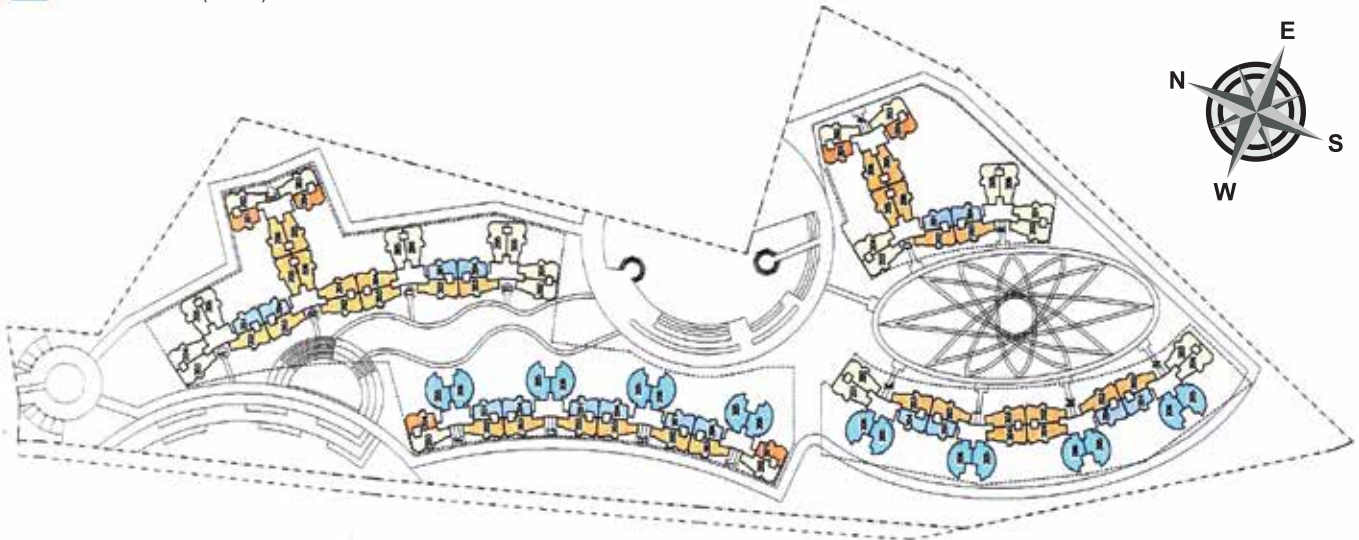

## LOCATION MAP

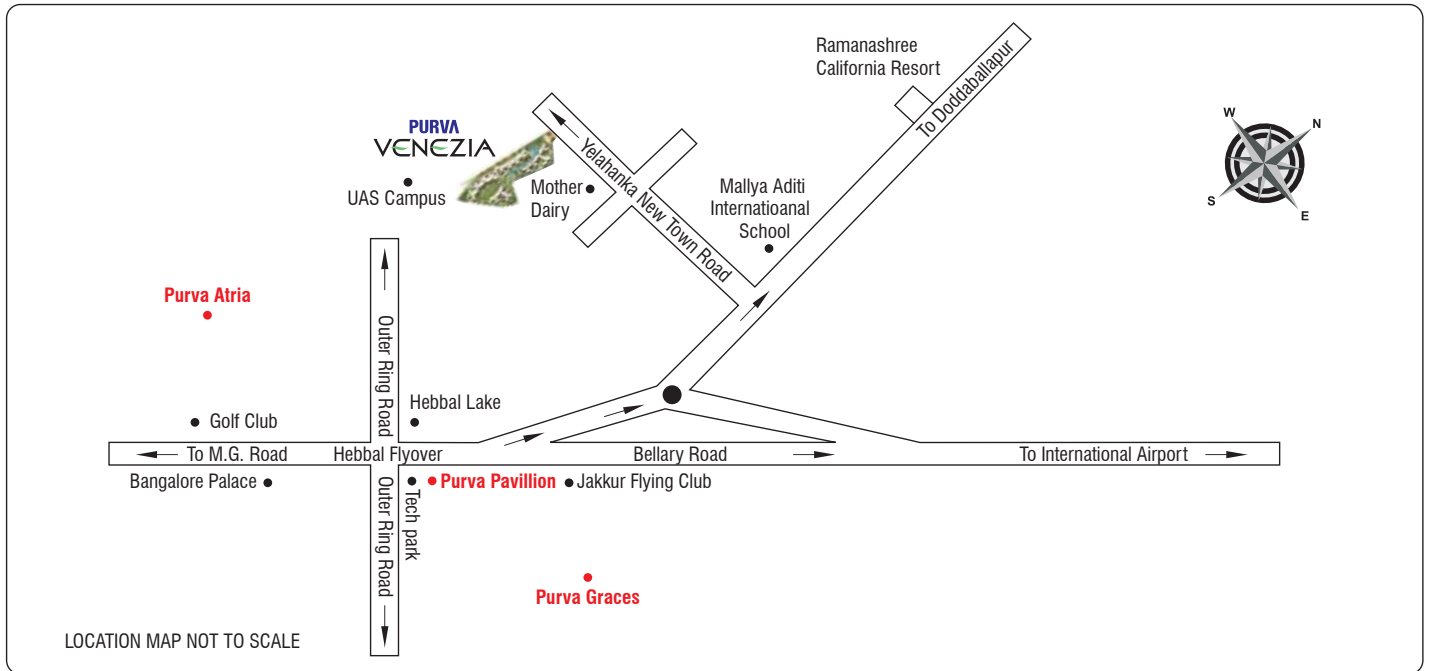

## PROXIMITY TO PURVA VENEZIA

5 kms from Yelahanka Railway Station | 5 kms from proposed Peripheral Ring Road | 10 kms from Hebbal Flyover | 18 kms from Bengaluru International Airport | 20 kms from Majestic Railway Station

## IN YOUR NEIGHBOURHOOD

### Nearby Hospitals

Columbia Asia Hospital | Cauvery Medical Centre | Bangalore Baptist Hospital | Dr. Agarwal's Eye Hospital

### Nearby Schools

Mallya Aditi International School | Ryan International School | Vidyashilp Academy | Delhi Public School | Canadian International School | TRIO World School | NITTE International School

### Nearby Colleges

NITTE Meenakshi Institute of Technology | BMS Institute of Technology | Seshadripuram PU College | Reva Institute of Technology and Management | Sir M Visvesvaraya Institute of Technology

### Nearby Shopping Centres and Restaurants

Esteem Mall | Big Bazaar | Food World | Reliance Fresh | More | Spencer's | Domino's | Pizza Corner | Shanthy Sagar | Cafe Coffee Day

### Nearby Clubs and Resorts

The Country Club | Ramanashree California Resort | Angsana Oasis Spa & Resorts | Silver Oak Resort | Fantasy Golf Resort | Chairman's Club & Resort

# Ready-to-move-in projects across India

- **Purva Highland**, Off Kanakapura Road, Bengaluru
- **Purva Venezia**, Yelahanka, Bengaluru
- **Purva Atria**, RMV IInd Stage, Bengaluru
- **Purva Oceana**, Marine Drive, Kochi
- **Purva Eternity**, Kakkanad, Kochi
- **Purva Moonreach**, On Seaport-Airport Road, Kochi

# On-going projects across India

- **Purva Whitehall**, On Sarjapur Main Road, Bengaluru
- **Purva Skywood**, Off Sarjapur Road, Bengaluru
- **Purva Midtown Residences**, Off Old Madras Road, Bengaluru
- **Purva Platina**, RMV IInd Stage, Bengaluru
- **Purva Season**, C.V. Raman Nagar, Bengaluru
- **Purva Sunflower**, at Rajajinagar, Bengaluru
- **Purva GrandBay**, Marine Drive, Kochi
- **Purva Swanlake**, OMR, Chennai
- **Purva Windermere**, Pallikaranai, Chennai
- **Purva Bluemont**, Singanallur, Trichy Road, Coimbatore

**Chennai**  
Call: +91-44- 44 55 55 55

**Coimbatore**  
Call: +91-422- 44 55 555

**Kochi**  
Call: +91-484- 44 55 555

**Dubai**  
Call: +971-4-3595818

**Saudi Arabia**  
Call: +966-3-8946459

## PURAVANKARA

**Call: +91 80 44 55 55 55**

Corporate sales office on Ulsoor Road open from 9 am to 6 pm on all days

Corporate / Regional Office: Puravankara Projects Limited, 130/1, Ulsoor Road, Bangalore - 560 042.  
Site Address: Survey No. 5/2, Mandalakunte Village, GKVK post, Yelahanka Hobli, Bangalore North Taluk - 560 064.

**Website: [www.puravankara.com](http://www.puravankara.com) | Email: [sales@puravankara.com](mailto:sales@puravankara.com)**

*Purva Venezia is financed by Trustee Partner: IL&FS Trust Company Limited. Loans available from all leading banks.*

This is a copyright material for only Puravankara Projects Limited

